

drawn left

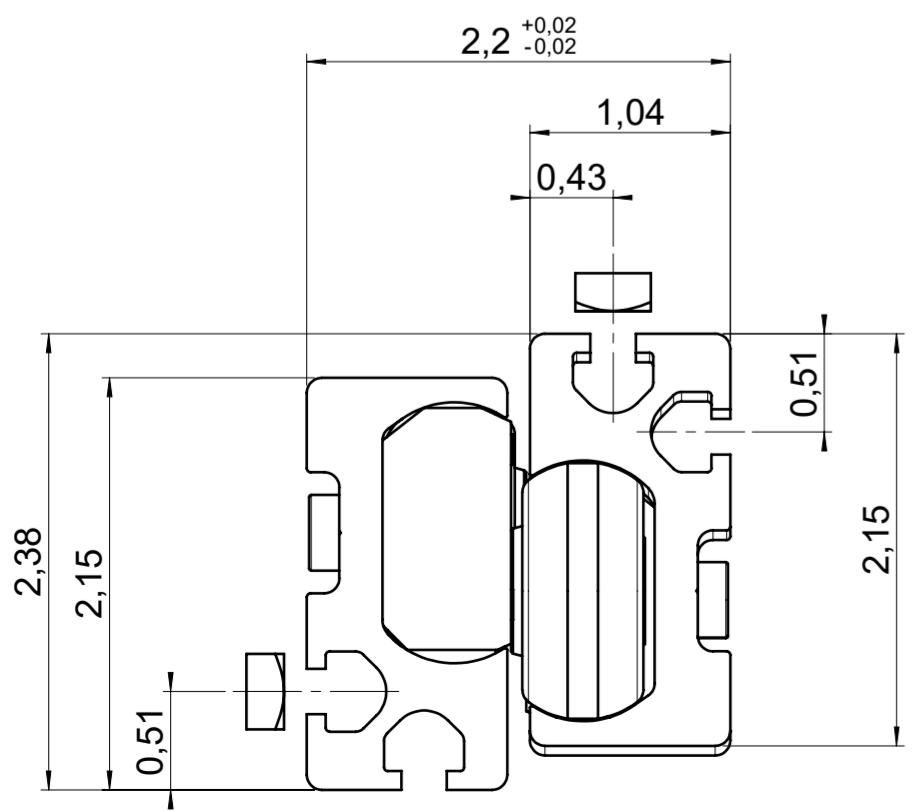
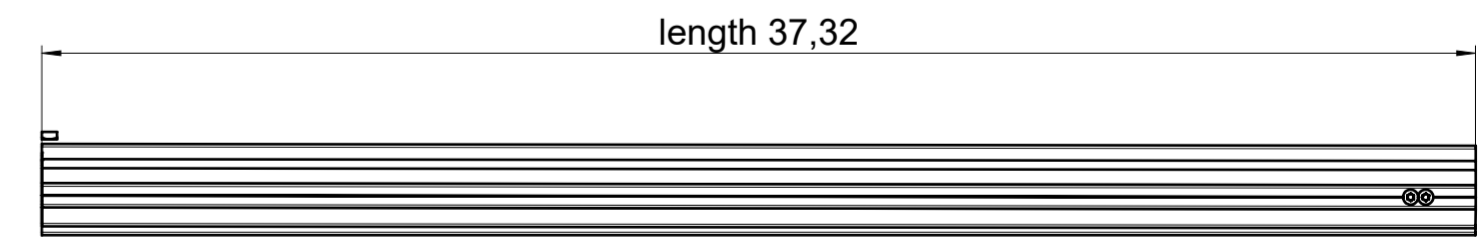
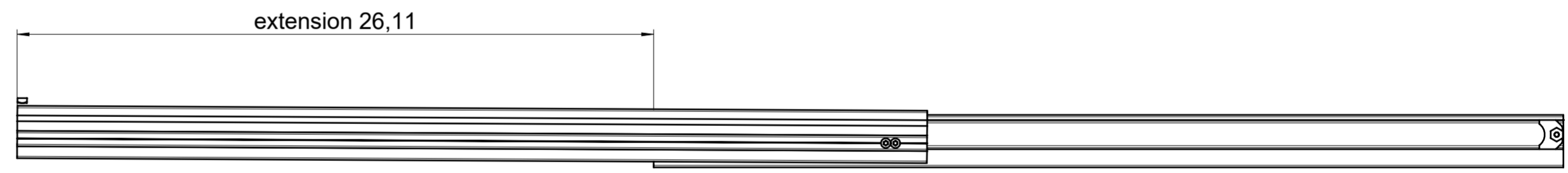
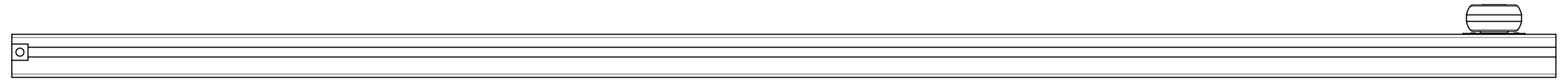
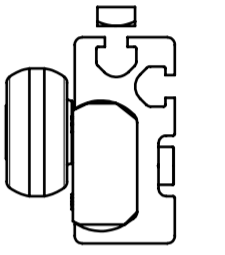
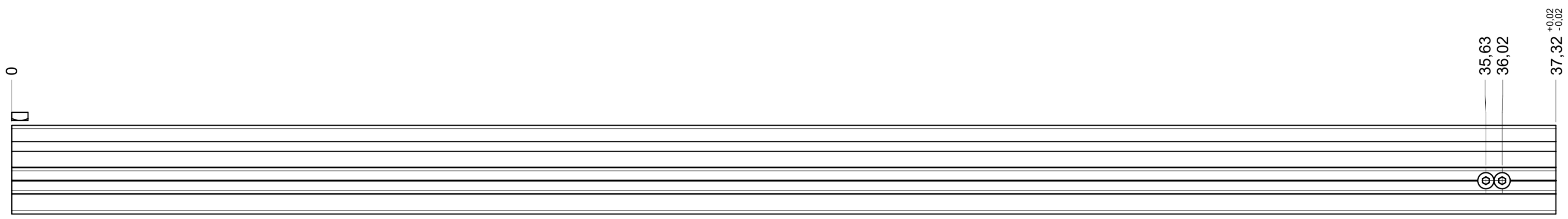
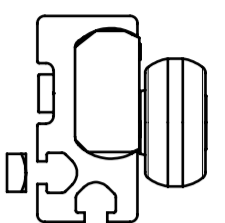
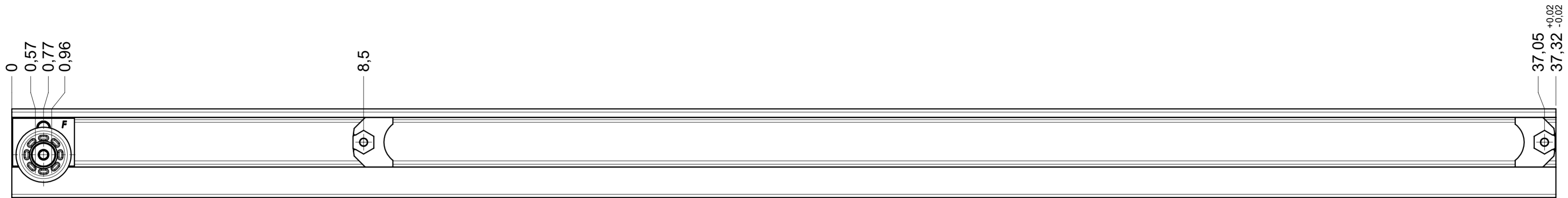

final approval

customer name:

signed by:

date:

all dimensions in inch			DIN ISO 128-30 missing dimensions see 3D = theor. intersection	
This drawing remains our property and may not be multiplied neither be disclosed to third parties (§§1,3 and 5 from the copyright Act (UrhG)) covered according to DIN ISO 16016				
(k) (l) (i) (h) (g) (f) (e) (d) (c) (b) (a)	scale:	1:2	surface:	material, semi finished parts: CS (technical requirements Fulterer)
	drawn	01-02-2023	date	name
	proven	01-03-2023	date	name
			description: FR 9000 / 95 EN (inch) progressive-action full-extension drawerslide / side mount	
drawing number: 9000.950-GA.0000.li			replaces version date:	
ind.	changes	date	na.	

drawn right

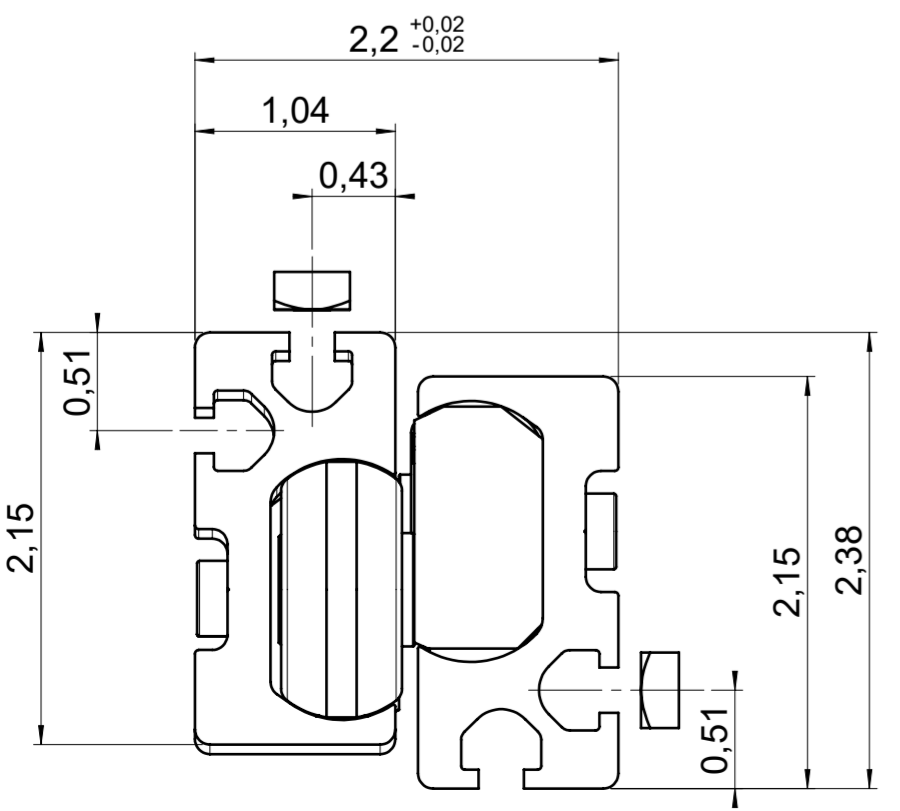
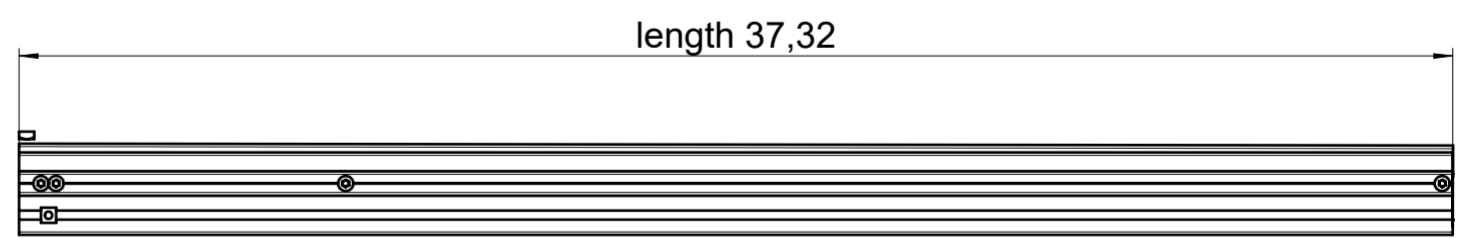
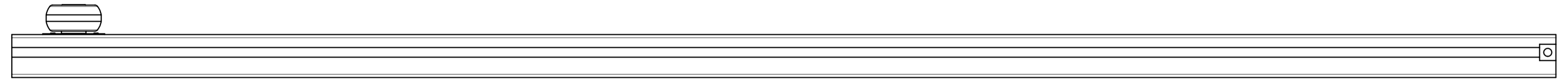
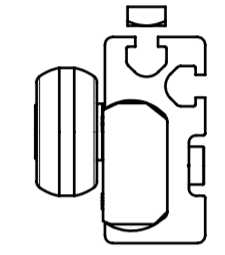
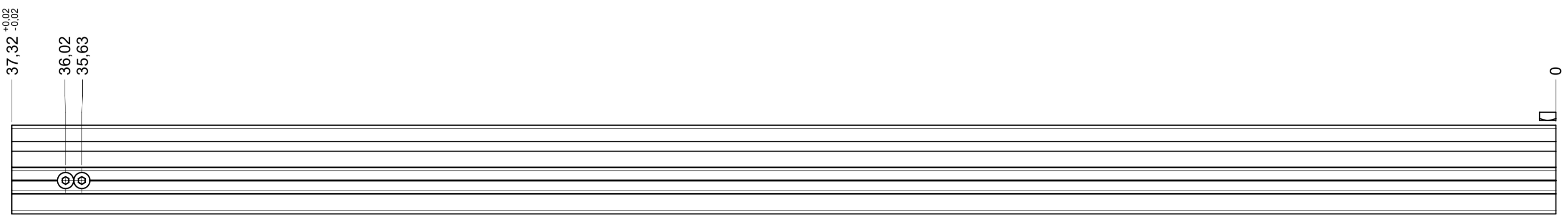
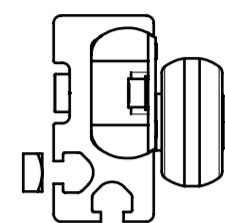
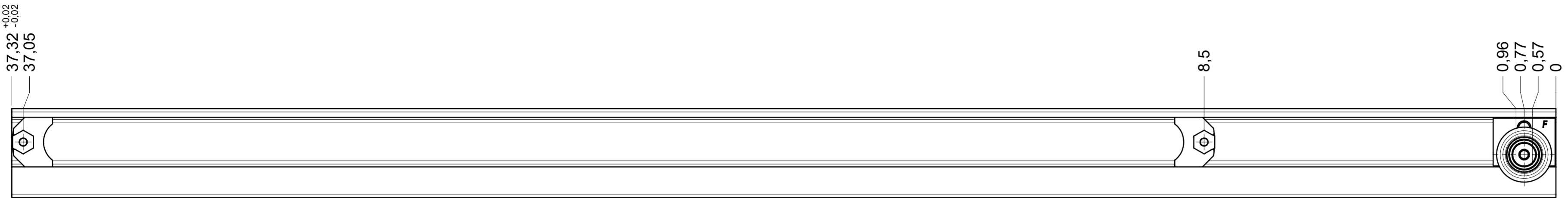

final approval

customer name:

signed by:

date:

all dimensions in inch

DIN ISO 128-30
missing dimensions see 3D
= theor. intersection

This drawing remains our property and may not be multiplied neither be disclosed to third parties (§§1,3 and 5 from the copyright Act (UrhG)) covered according to DIN ISO 16016				scale: 1:2	surface:	material, semi finished parts: CS (technical requirements Fulterer)	A2
(k)				date	name	description: FR 9000 / 95 EN (inch) progressive-action full-extension drawerslide / side mount	drawing number: 9000.950-GA.0000.re replaces version date:
(l)			drawn 01-02-2023	ex			
(h)			proven 01-03-2023	pr			
(g)				Fulterer			
(f)				Fulterer AG & Co KG A-6890 Lustenau / Austria			
(e)				Fulterer AG CH-9430 St. Margrethen			
(d)							
(c)							
(b)							
(a)							
ind.	changes	date	na.				