

drawn on the left (mirrored on the right)

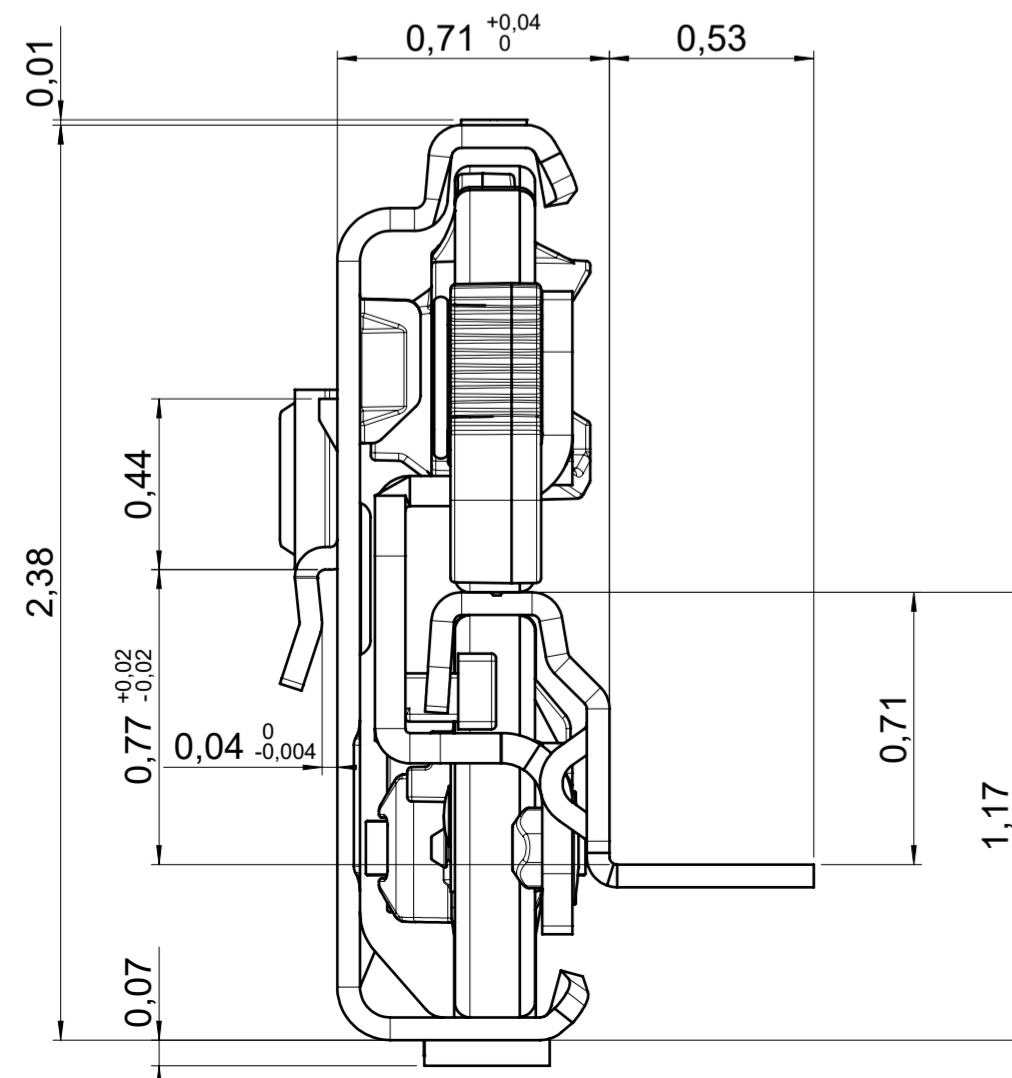
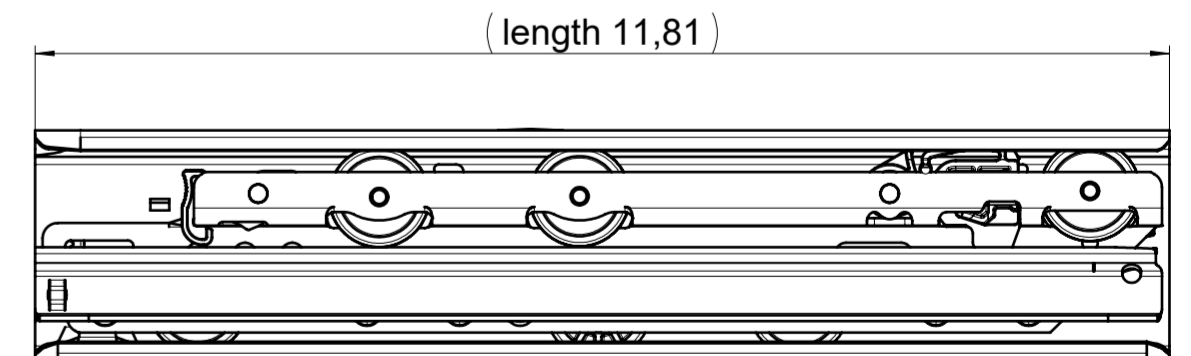
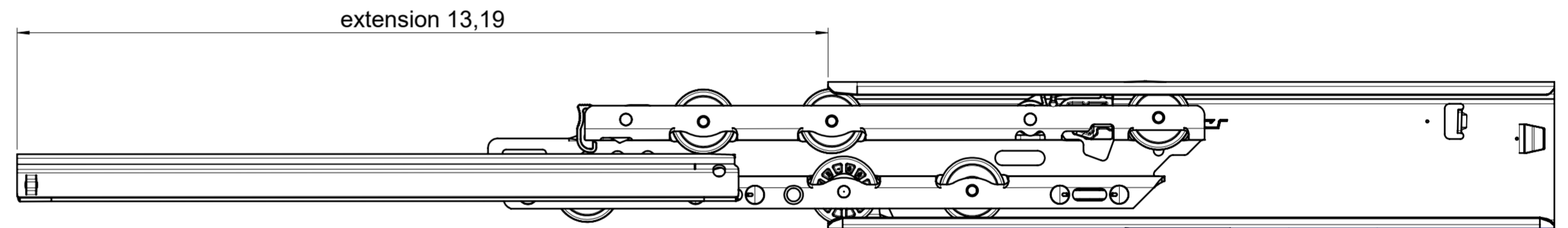
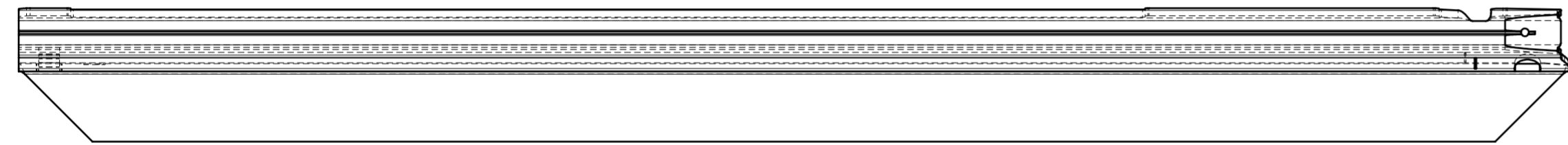
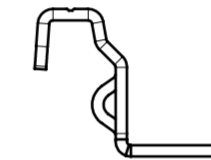
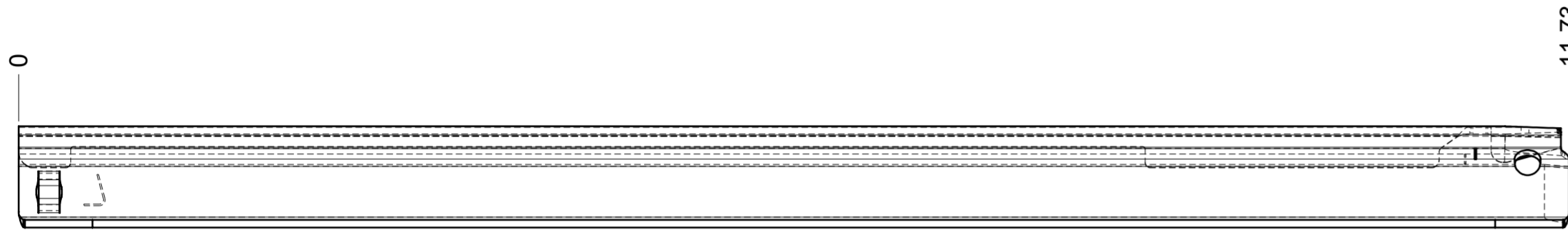
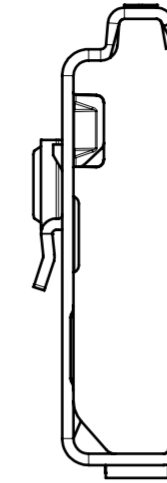
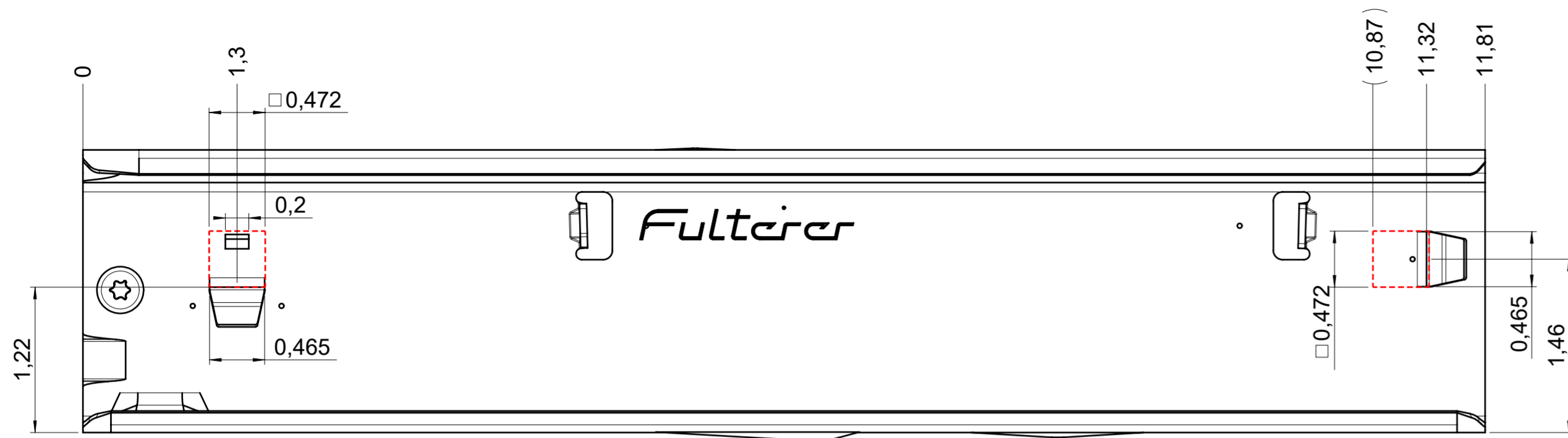

final approval	customer name:
	signed by:
	date:

all dimensions in inch			
missing dimensions see 3D = theor. intersection	scale: 1:1	surface/color:	material: CS (technical requirements Fulterer)
prototype approval	drawn: 2024-01-15 RK	date: 2024-01-15	description: FR 796-300 CS EN (inch) progressive-action over-extension drawerslide / bottom mount
	proven: 2024-01-15 RK		
ind. changes	date	name	drawing number: CS# 796.300-GA.L525
Fulterer AG & Co KG A-6890 Lustenau Fulterer AG CH-9430 St. Margrethen			replaces the edition:
This drawing remains our property and may not be multiplied neither be disclosed to third parties (§§1.3 and 5 from the copyright Act (UrhG)).			covered according to DIN ISO 16016