

drawn left

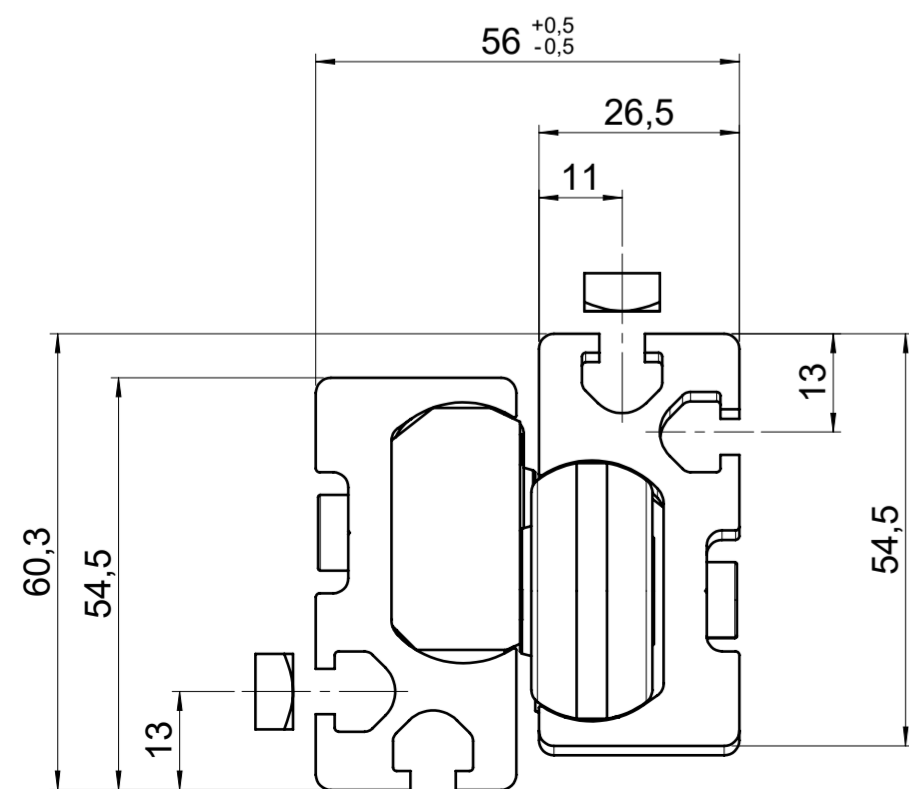
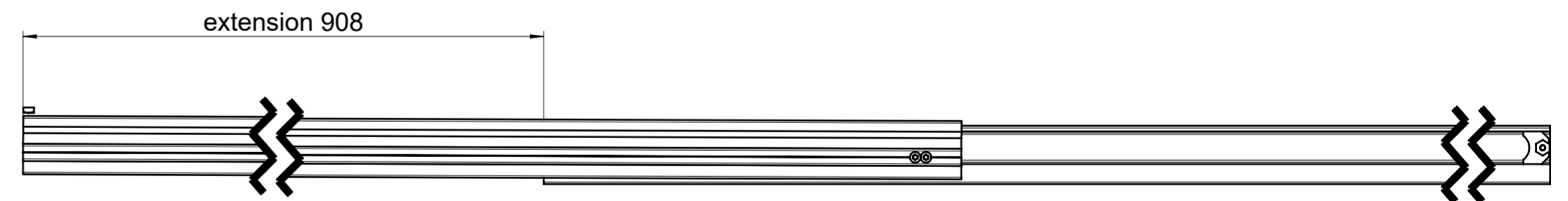
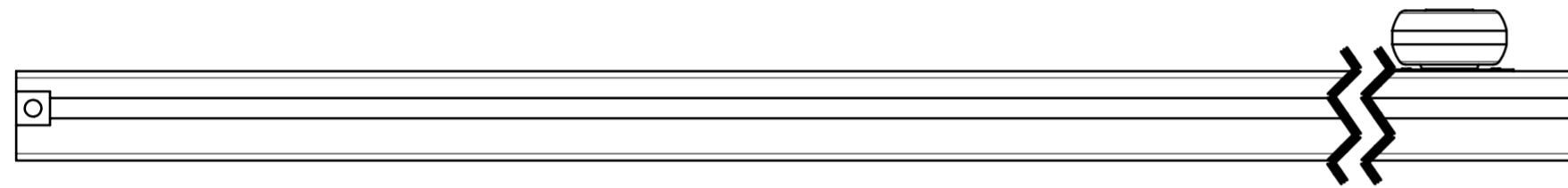
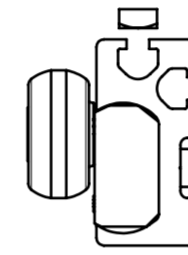
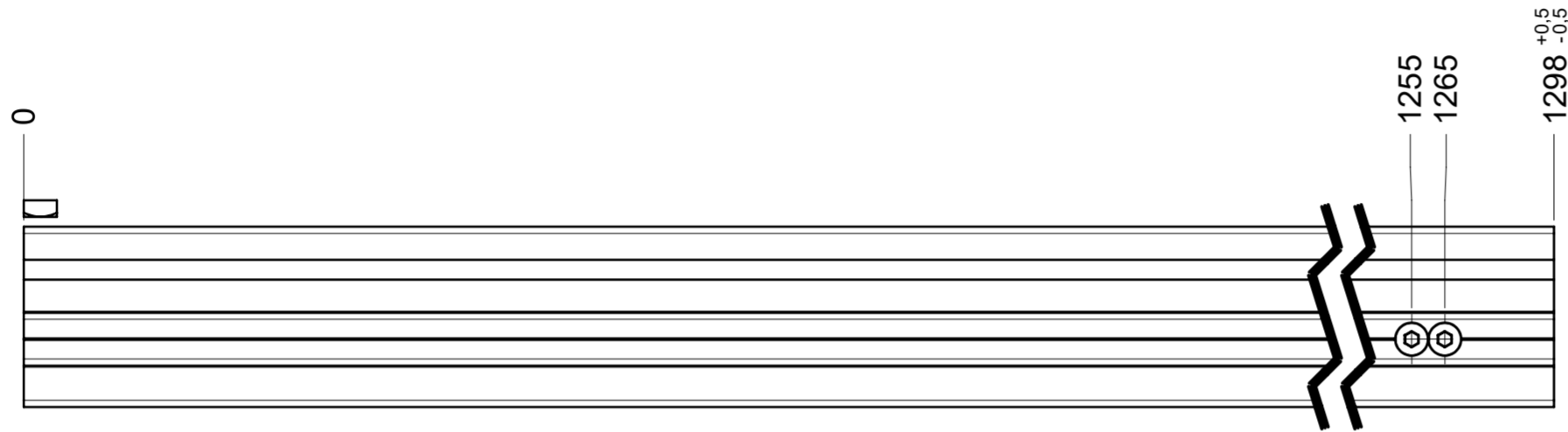
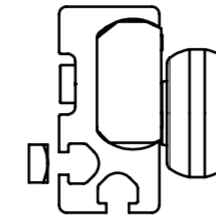
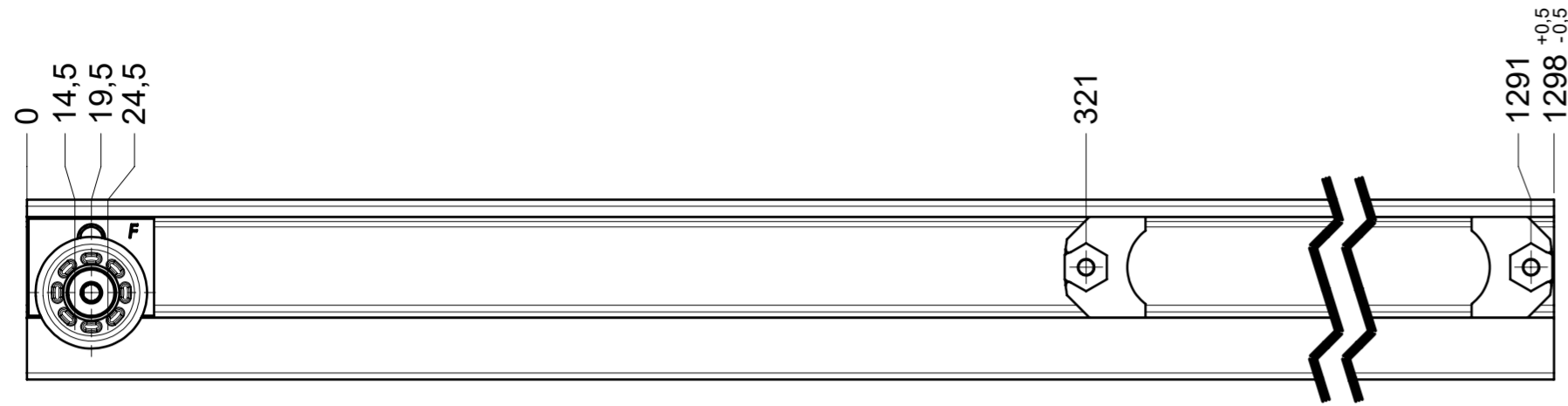

**final approval**

customer name:

signed by:

date:

**all dimensions in mm**

DIN ISO 128-30  
missing dimensions see 3D  
= theor. intersection

This drawing remains our property and may not be multiplied neither be disclosed to third parties (§§1,3 and 5 from the copyright Act (UrhG)) covered according to DIN ISO 16016

(k) (l) (i) (h) (g) (f) (e) (d) (c) (b) (a)	scale:	1:2	surface:	material, semi finished parts:	A2
	drawn	01-02-2023	date	name	CS
	proven	01-03-2023	date	name	(technical requirements Fulterer)
	description: FR 9000 / 130 EN (mm) progressive-action full-extension drawerslide / side mount		drawing number: <b>9000.1300-GA.0000.li</b> replaces version date:		
ind.	changes	date	na.	Fulterer AG & Co KG A-6890 Lustenau / Austria Fulterer AG CH-9430 St. Margrethen	

drawn right

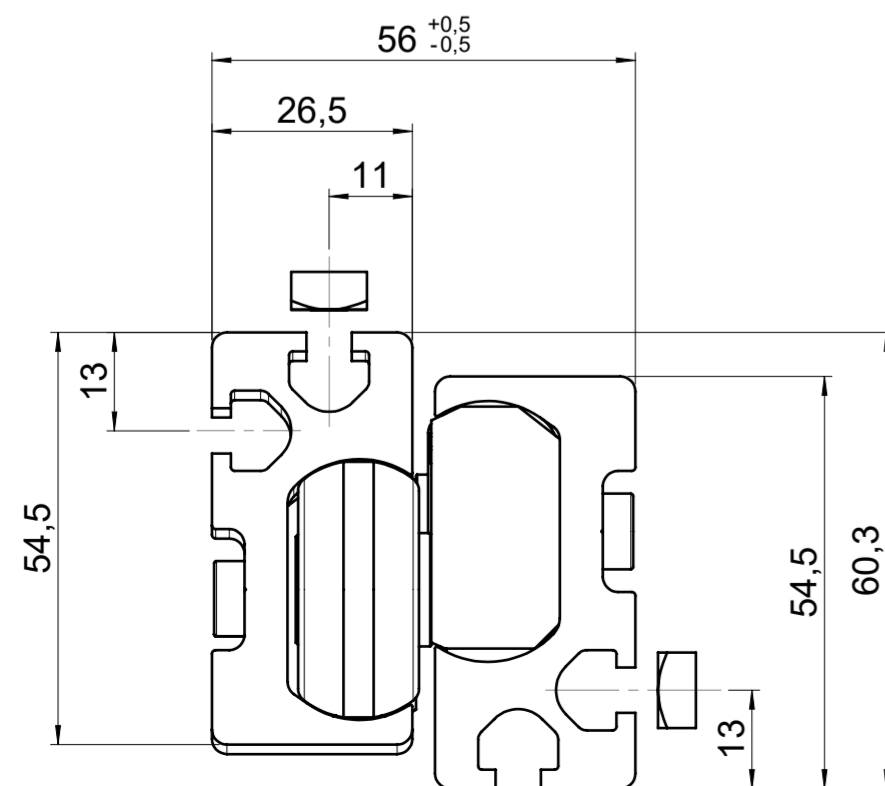
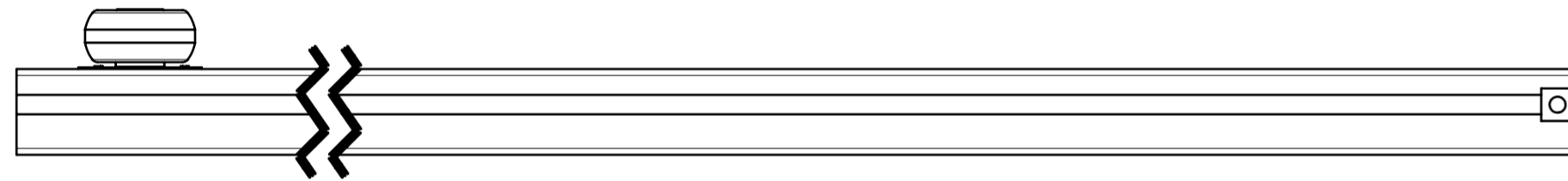
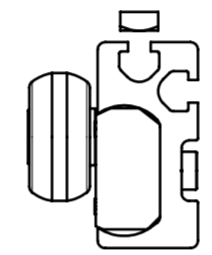
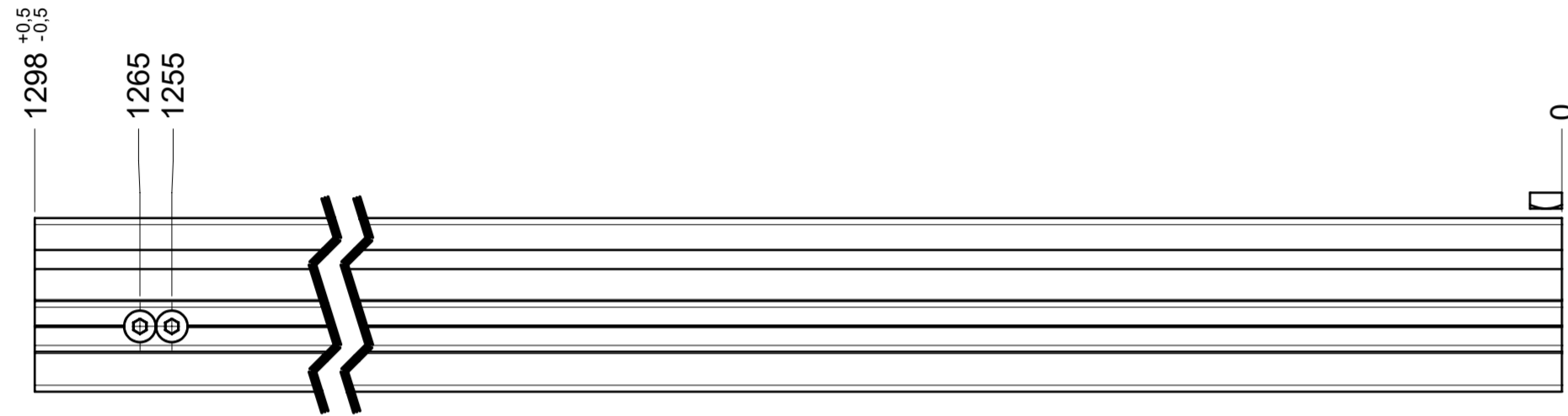
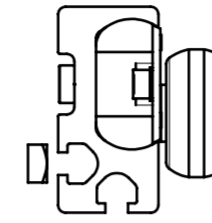
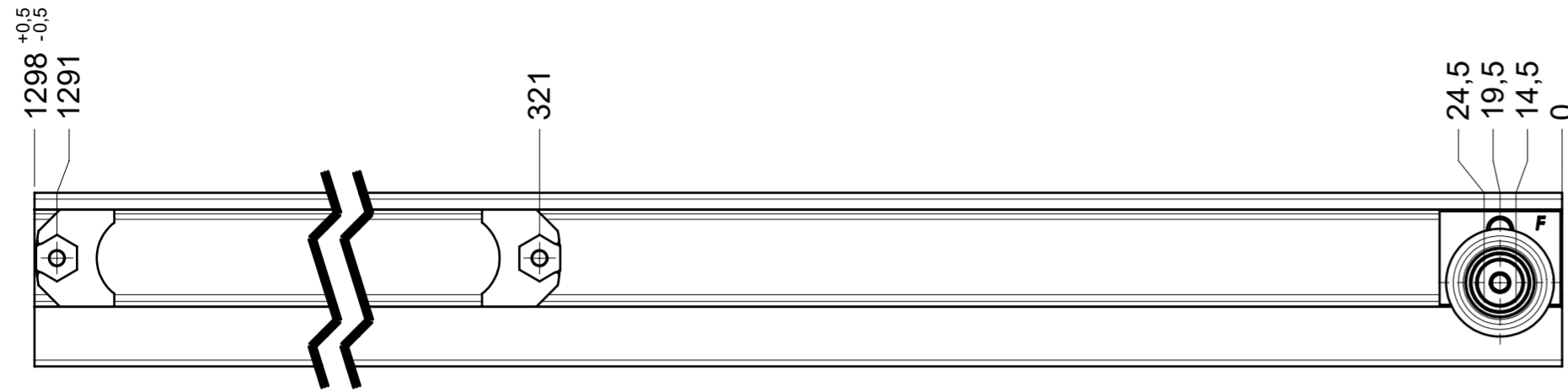

**final approval**

customer name:

signed by:

date:

**all dimensions in mm**

DIN ISO 128-30  
missing dimensions see 3D  
= theor. intersection

This drawing remains our property and may not be multiplied neither be disclosed to third parties (§§1,3 and 5 from the copyright Act (UrhG)) covered according to DIN ISO 16016

(k) (l) (i) (h) (g) (f) (e) (d) (c) (b) (a)	scale:	1:2	surface:	material, semi finished parts:	A2
	drawn	01-02-2023	date	name	CS
	proven	01-03-2023	date	name	(technical requirements Fulterer)
					description:
Fulterer AG & Co KG A-6890 Lustenau / Austria Fulterer AG CH-9430 St. Margrethen				drawing number:	9000.1300-GA.0000.re
ind. changes      date      na.				replaces version date:	