

drawn left

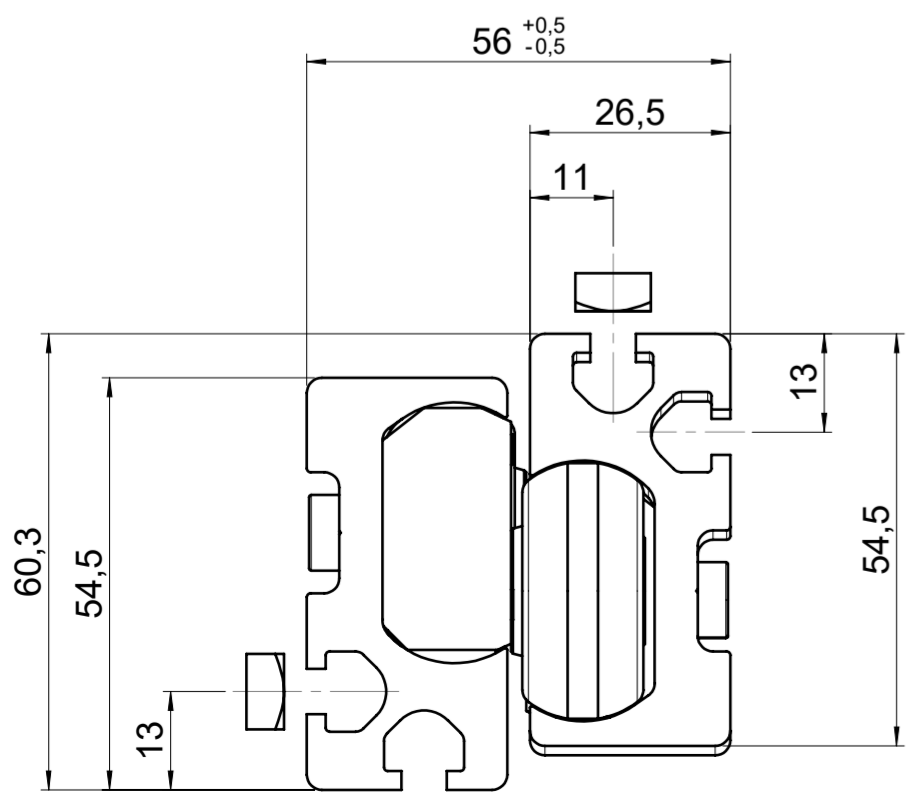
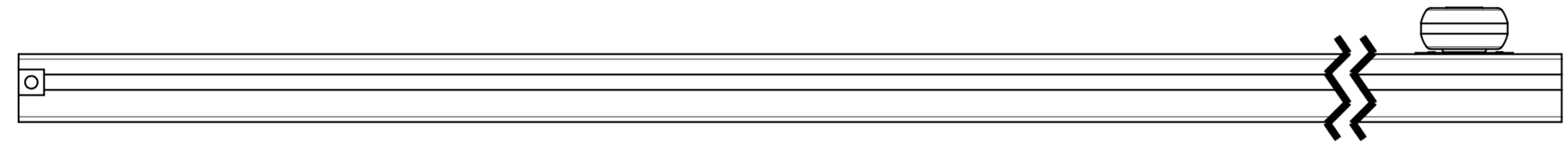
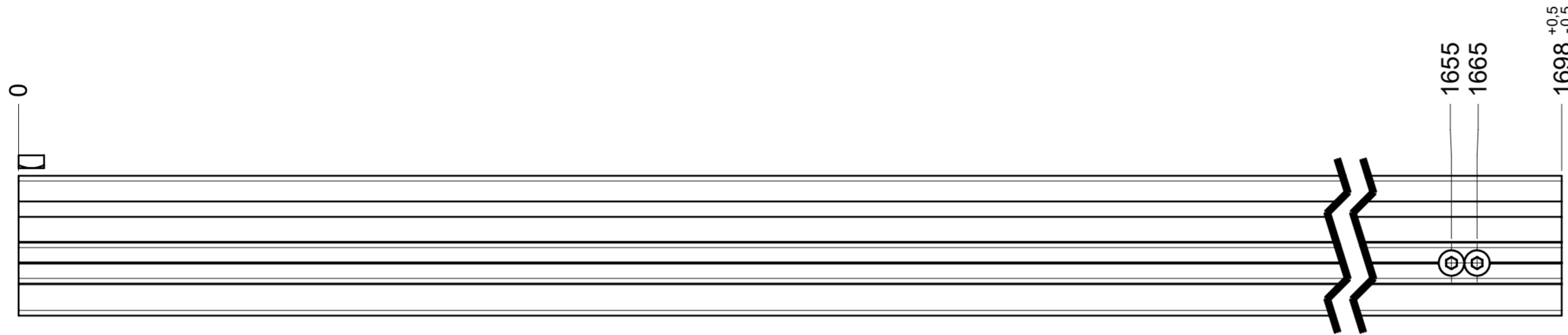
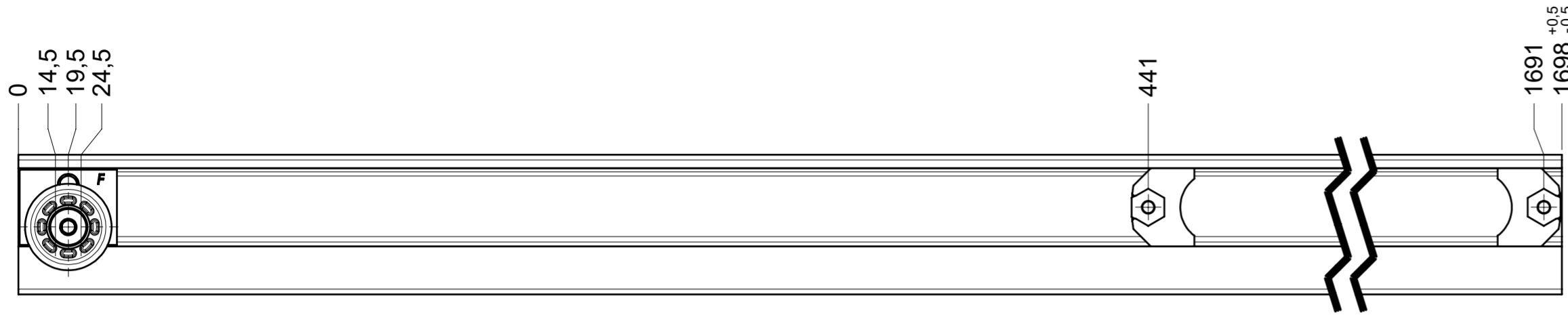

final approval

customer name:

signed by:

date:

all dimensions in mm				DIN ISO 128-30 missing dimensions see 3D = theor. intersection	
This drawing remains our property and may not be multiplied neither be disclosed to third parties (§§1,3 and 5 from the copyright Act (UrhG)) covered according to DIN ISO 16016					
scale: 1:2		surface:		material, semi finished parts: CS (technical requirements Fulterer)	
drawn	date	name		description:	
proven	01-02-2023	ex		FR 9000 / 170 EN (mm)	
Fulterer		pr		progressive-action full-extension drawerslide / side mount	
Fulterer AG & Co KG A-6890 Lustenau / Austria				drawing number:	
Fulterer AG CH-9430 St. Margrethen				9000.1700-GA.0000.li	
changes				replaces version date:	

drawn right

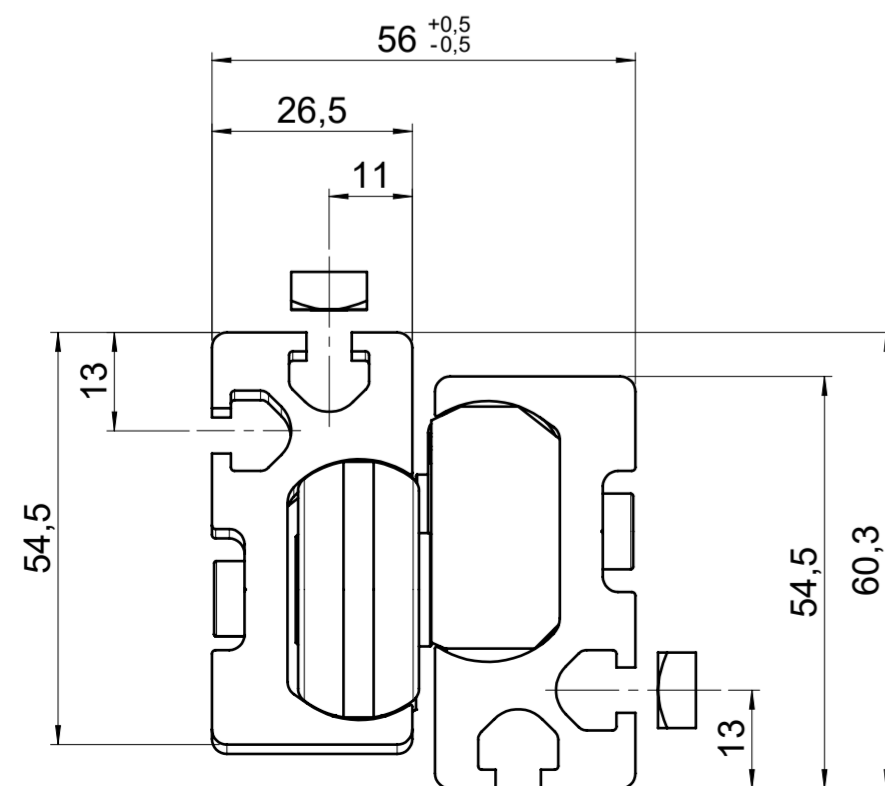
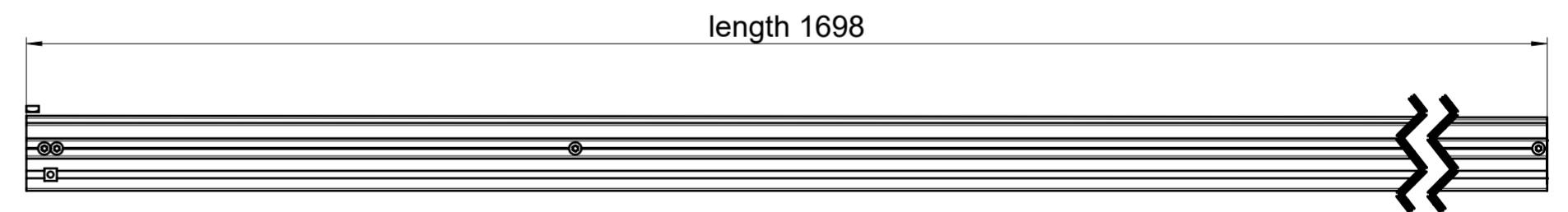
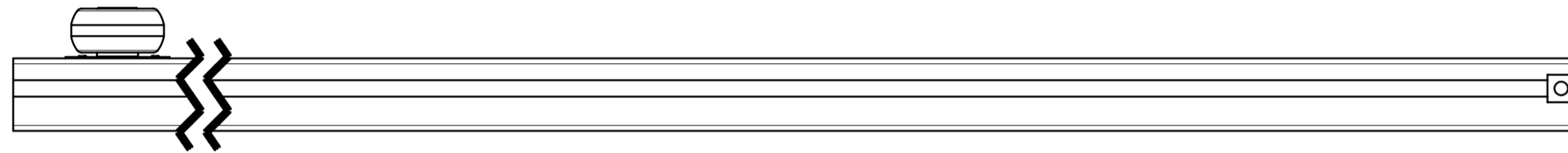
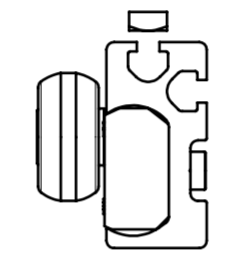
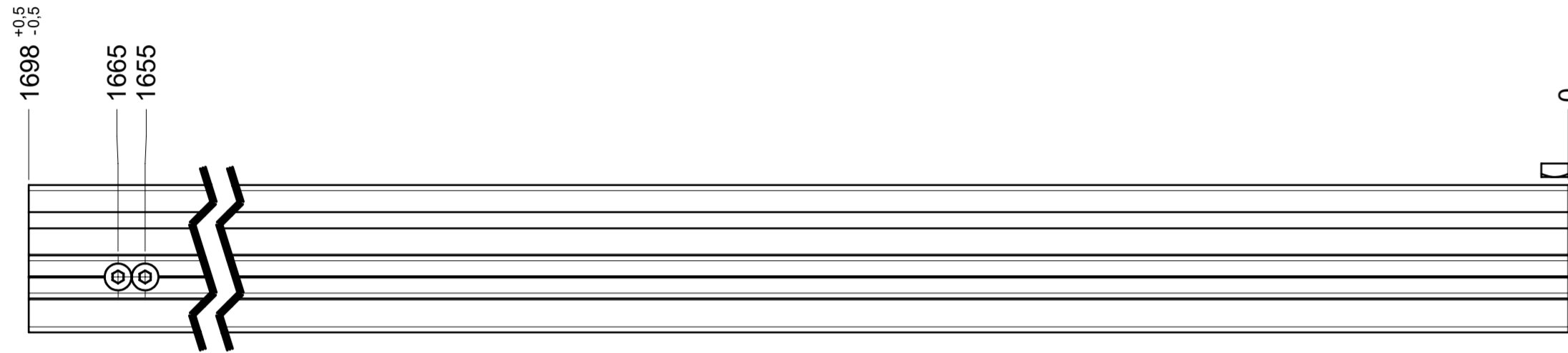
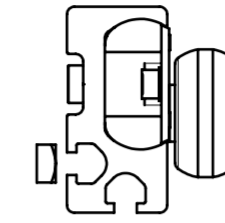
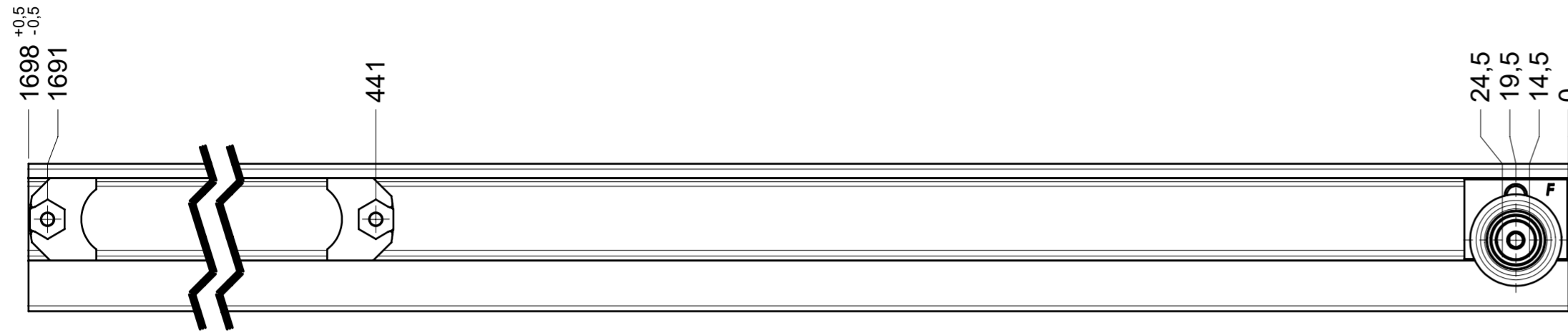

final approval

customer name:

signed by:

date:

all dimensions in mm

DIN ISO 128-30
missing dimensions see 3D
= theor. intersection

This drawing remains our property and may not be multiplied neither be disclosed to third parties (§§1,3 and 5 from the copyright Act (UrhG)) covered according to DIN ISO 16016				scale: 1:2	surface:	material, semi finished parts: CS (technical requirements Fulterer)	A2
(k)				drawn	date	name	description: FR 9000 / 170 EN (mm) progressive-action full-extension drawerslide / side mount
(l)				proven	01-02-2023	ex	
(h)					01-03-2023	pr	
(g)							
(f)							drawing number: 9000.1700-GA.0000.re
(e)							
(d)							
(c)							
(b)				Fulterer AG & Co KG A-6890 Lustenau / Austria			replaces version date:
(a)				Fulterer AG CH-9430 St. Margrethen			
ind.	changes	date	na.				