

drawn left

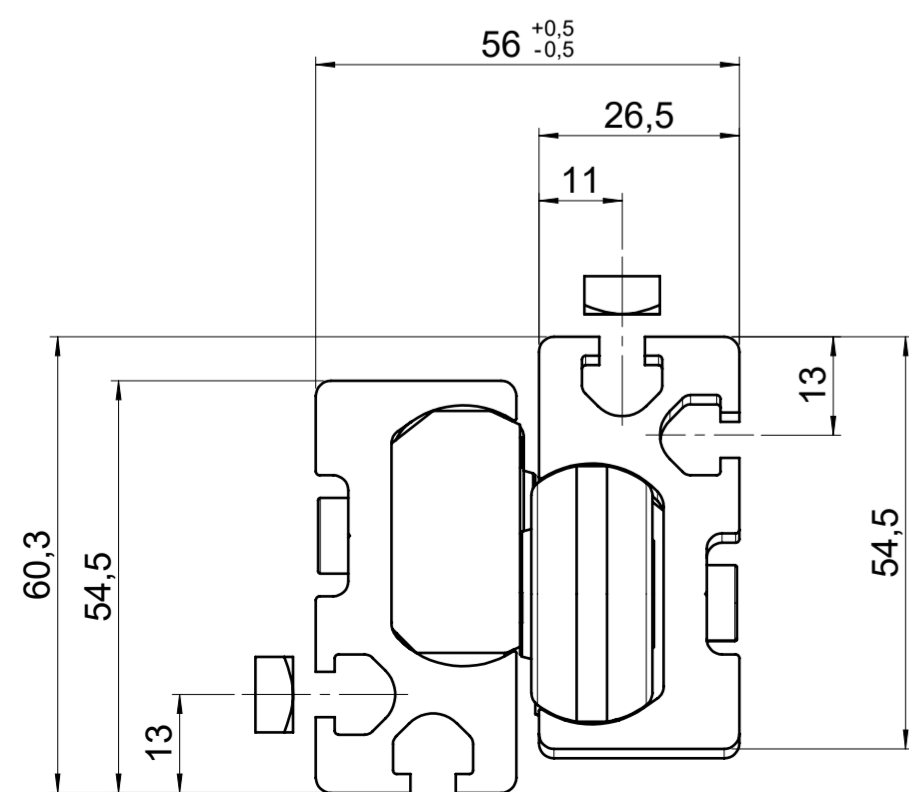
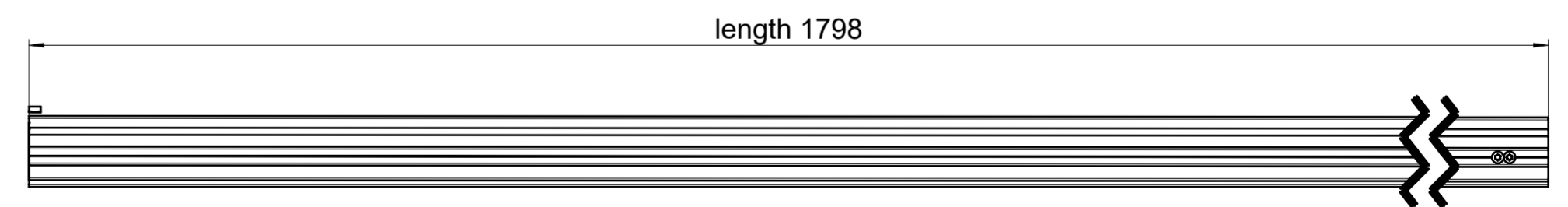
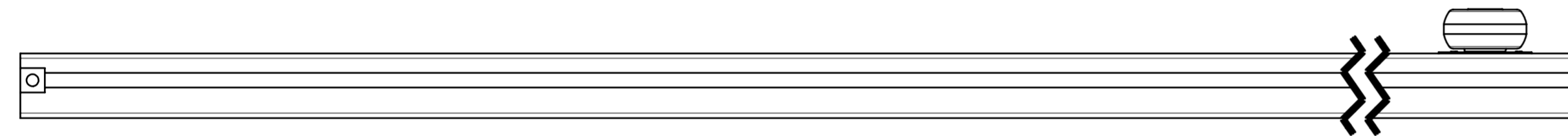
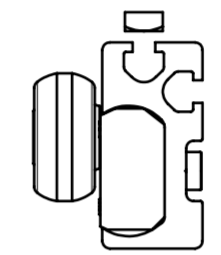
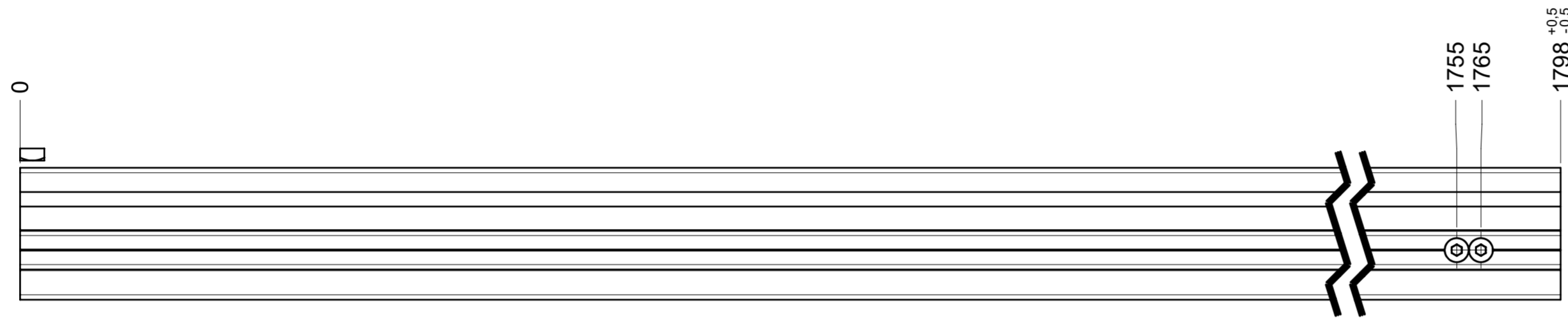
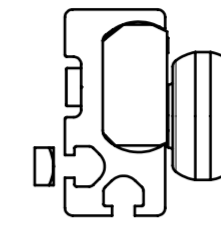
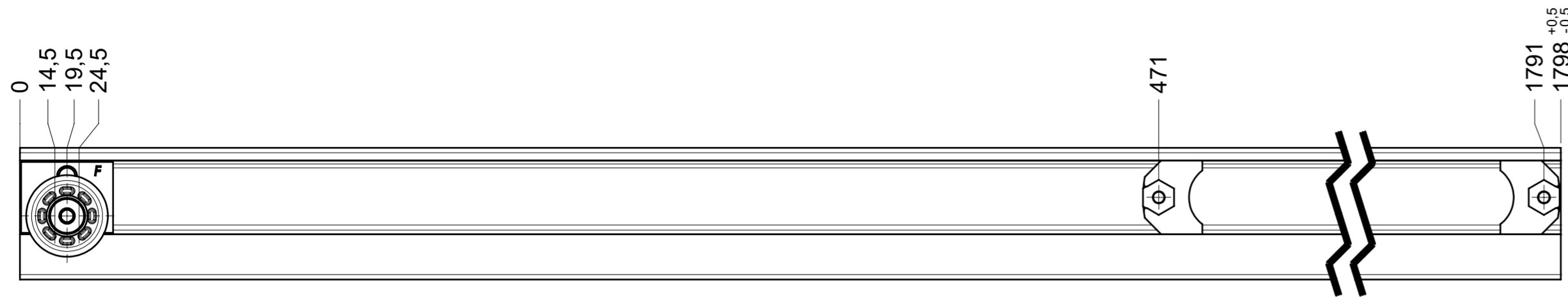

final approval

customer name:

signed by:

date:

all dimensions in mm

DIN ISO 128-30
missing dimensions see 3D
= theor. intersection

This drawing remains our property and may not be multiplied neither be disclosed to third parties (§§1,3 and 5 from the copyright Act (UrhG)) covered according to DIN ISO 16016				scale:	surface:	material, semi finished parts:	A2
(k)				1:2		CS	
(l)				date	name	(technical requirements Fulterer)	
(h)				drawn 01-02-2023	ex	description: FR 9000 / 180 EN (mm) progressive-action full-extension drawerslide / side mount	
(f)				proven 01-03-2023	pr		
(e)						drawing number: 9000.1800-GA.0000.li	
(d)							
(c)				Fulterer AG & Co KG A-6890 Lustenau / Austria		replaces version date:	
(b)				Fulterer AG CH-9430 St. Margrethen			
(a)				ind.	changes	date	na.

drawn right

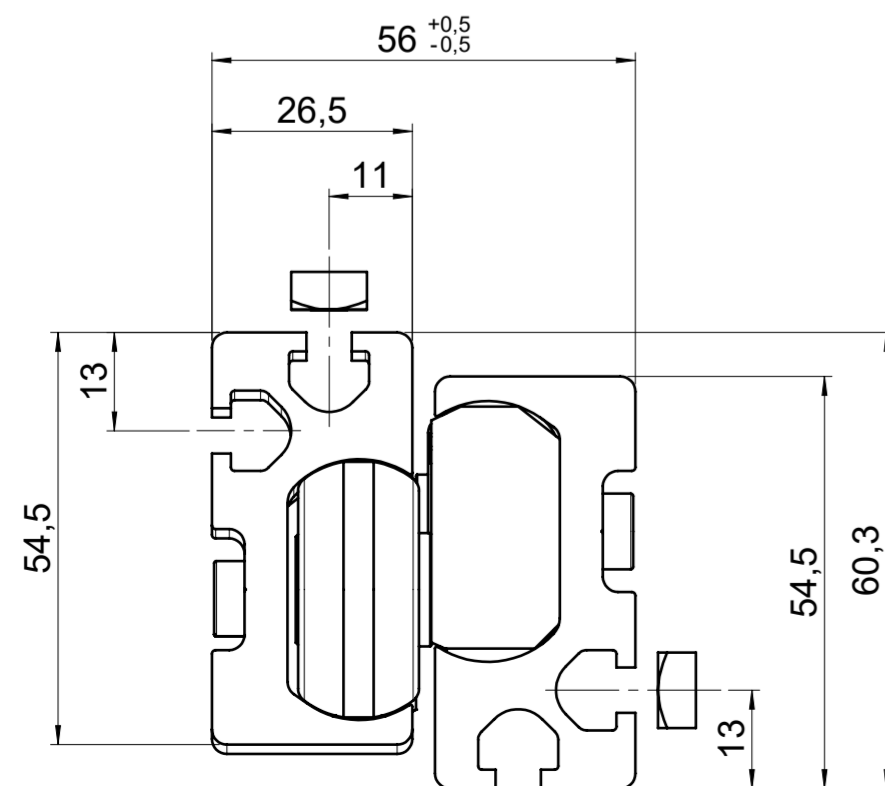
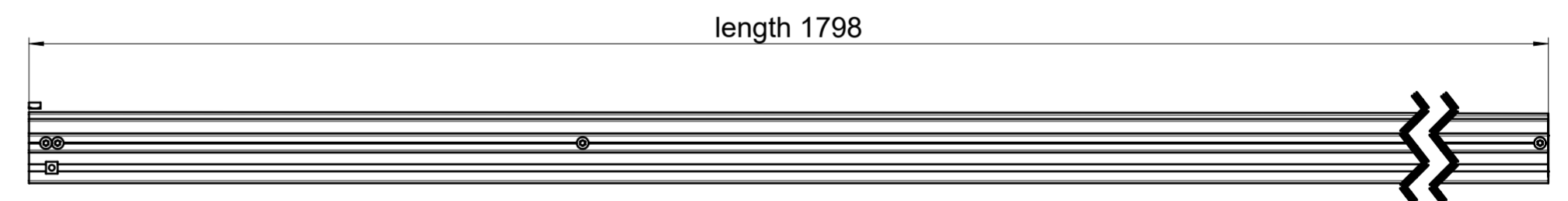
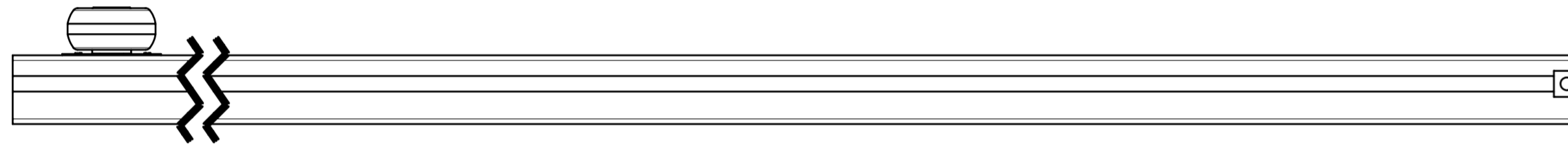
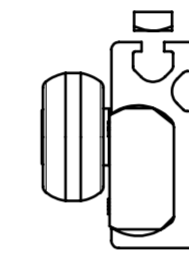
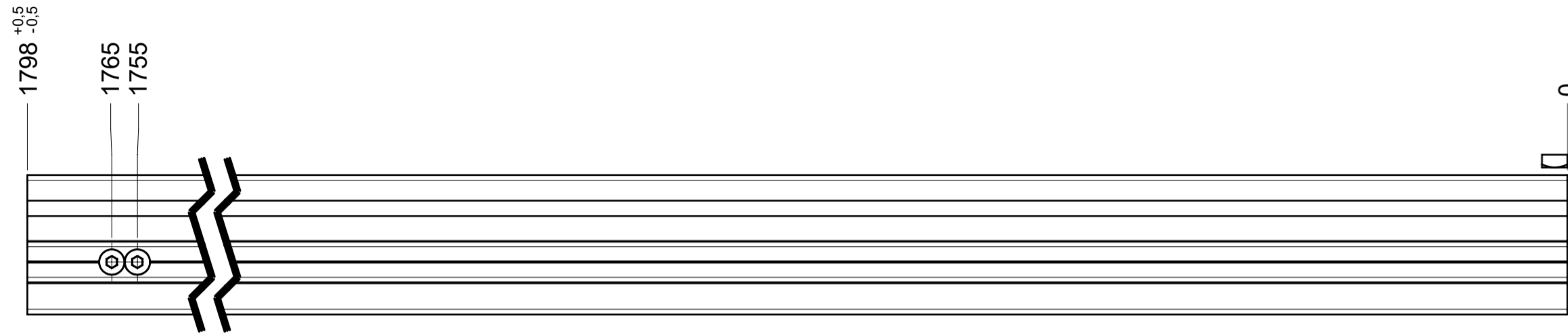
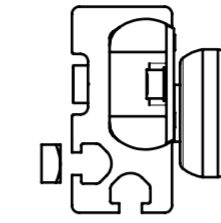
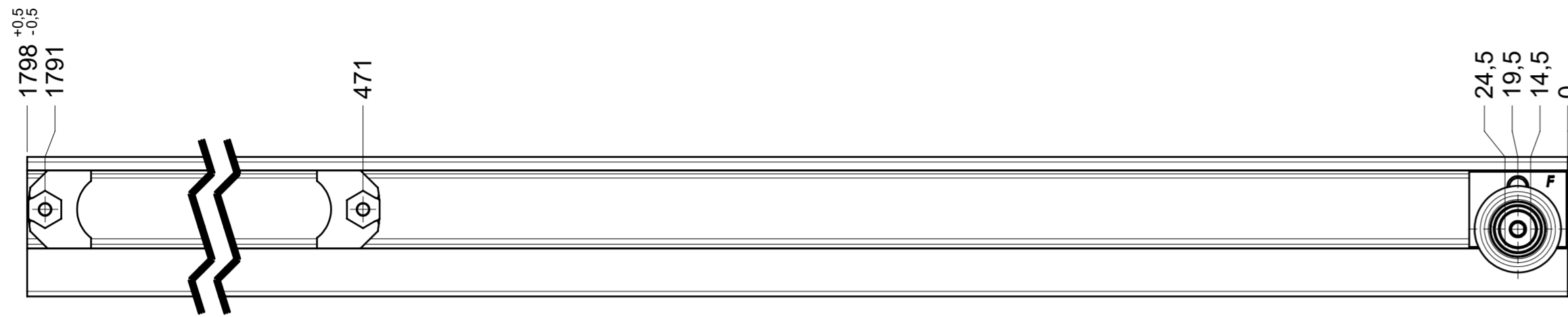

final approval

customer name:

signed by:

date:

all dimensions in mm

DIN ISO 128-30
missing dimensions see 3D
= theor. intersection

This drawing remains our property and may not be multiplied neither be disclosed to third parties (§§1,3 and 5 from the copyright Act (UrhG)) covered according to DIN ISO 16016				scale: 1:2	surface:	material, semi finished parts: CS (technical requirements Fulterer)	A2
(k)				date	name	description: FR 9000 / 180 EN (mm) progressive-action full-extension drawerslide / side mount	drawing number: 9000.1800-GA.0000.re replaces version date:
(l)			drawn 01-02-2023	ex			
(h)			proven 01-03-2023	pr			
(g)				Fulterer			
(f)				Fulterer AG & Co KG A-6890 Lustenau / Austria			
(e)				Fulterer AG CH-9430 St. Margrethen			
(d)							
(c)							
(b)							
(a)							
ind.	changes	date	na.				